

LTECH

UX1 Touch Panel (Dimming)



Manual

www.ltech-led.com

Technical Specs

UX1 Dimming Touch Panel

Input Voltage: 5Vdc, 0.5A-1A (with an adapter)	Working Temp.: -30°C~55°C
Output Signal: RF 2.4GHz, DMX512	Package Size: L132xW192xH50(mm)
Control Mode: Dimming	Weight(N.W.): 230g
	Weight(G.W.): 370g

R4-3A Constant Voltage Receiver (receiver is sold separately)

Wireless Signal: RF 2.4GHz	Working Temp.: -30°C~55°C
Input Voltage: 5-24Vdc	Package Size: L127xW35xH24(mm)
Current Load: 3A x 4CH Max. 12A	Weight(G.W.): 60g
Output Power: Max 60W/144W/288W(5V/12V/24V)	

R4-5A Constant Voltage Receiver (receiver is sold separately)

Wireless Signal: RF 2.4GHz	Working Temp.: -30°C~55°C
Input Voltage: 5-24Vdc	Package Size: L178xW48xH33(mm)
Current Load: 5A x 4CH Max. 20A	Weight(G.W.): 150g
Output Power: Max 100W/240W/480W(5V/12V/24V)	

R4-CC Constant Current Receiver (receiver is sold separately)

Wireless Signal: RF 2.4GHz	Working Temp.: -30°C~55°C
Input Voltage: 12-48Vdc	Package Size: L178xW48xH33(mm)
Output Voltage: 3-46Vdc	Weight(G.W.): 165g
Output Current: CC 350/700/1050mAx4CH	
Output Power: 1.05W-48.3Wx4CH Max 193.2W	

Product Size:

The Unit: mm

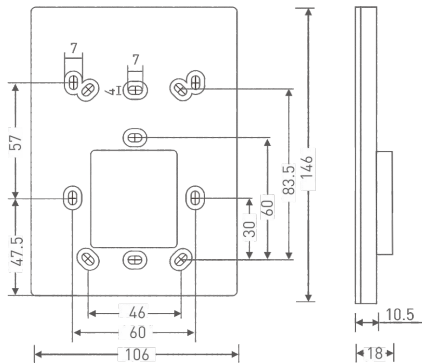

Touch Panel

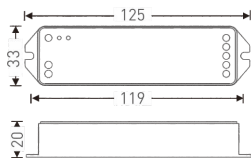

R4-3A

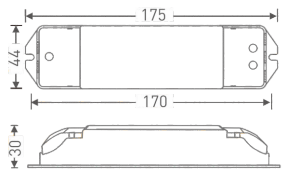

R4-5A/R4-CC

Terminals

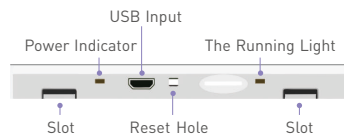
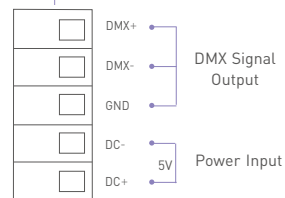
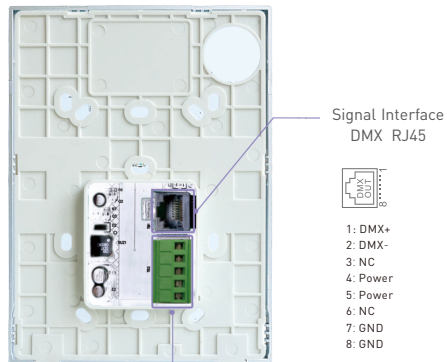

Installation Instruction:

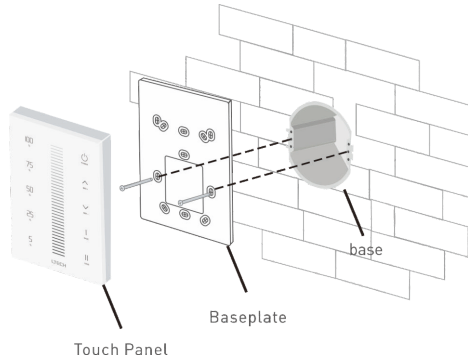

1. Install the base into the wall. Typical bases as below:

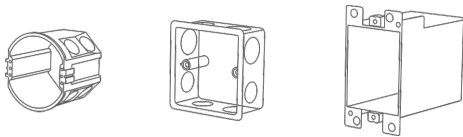

2. Use a straight screwdriver to pry the position shown:

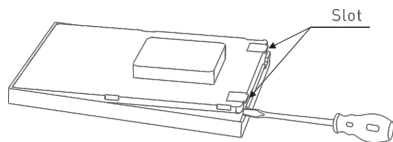

3. Screw the baseplate and the base in the wall firmly.

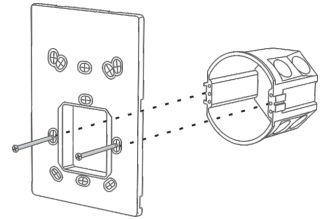

4. Connect in a right way and put the power adapter into the base.

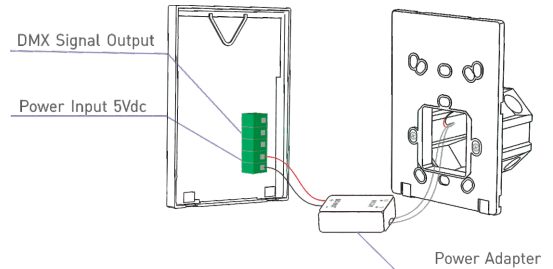

Key Functions

- 5 Embed the upper touch panel into the baseplate and then tap the bottom to press into the slots.

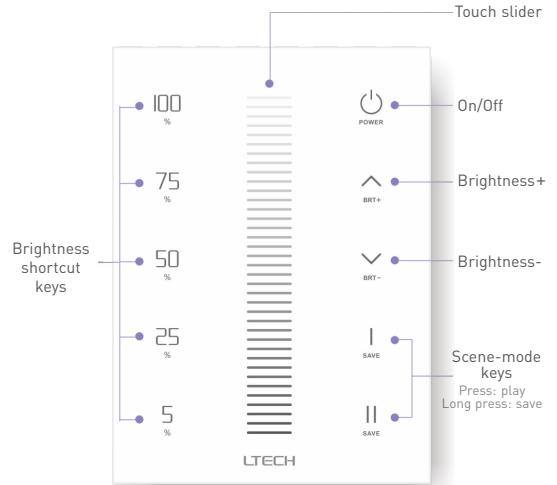
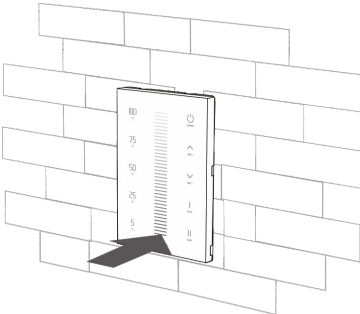
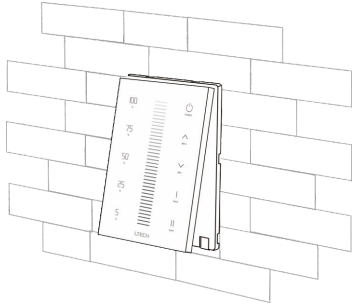

* When UX1 is off, long press  to turn on/off the tone.

Application Composition

DMX512 Signal Output :

- Touch panel (UX1)
- Touch panel (UX1) + Remote (V1)
- Touch panel (UX1) + WiFi master controller (WiFi-104)
- Touch panel (UX1) + WiFi master controller (WiFi-104) + Remote (V1)

Wireless Control:

- Touch panel (UX1) + Wireless receiver (R4-3A/5A, R4-CC)
- Touch panel (UX1) + Remote (V1) + Wireless receiver (R4-3A/5A, R4-CC)
- Touch panel (UX1) + WiFi master controller (WiFi-104) + Wireless receiver (R4-3A/5A, R4-CC)
- Touch panel (UX1) + WiFi master controller (WiFi-104) + Remote (V1) + Wireless receiver (R4-3A/5A, R4-CC)

DMX Output Wiring

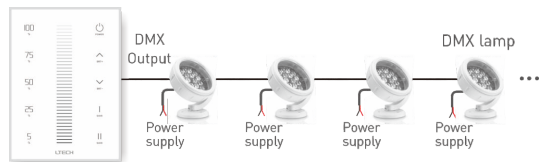
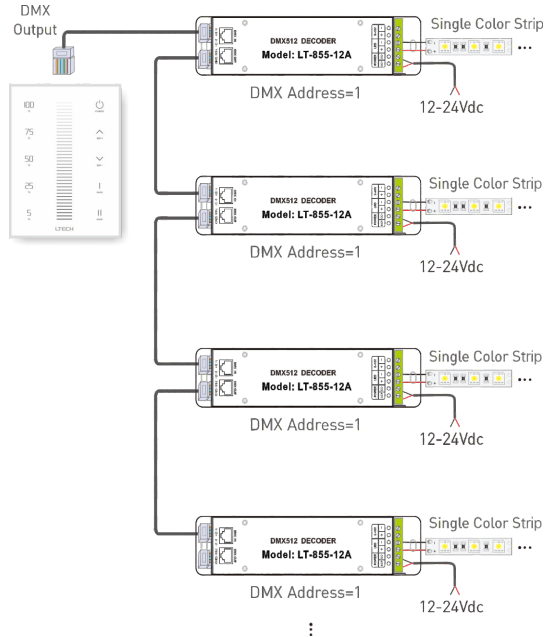

RF Wireless Wiring

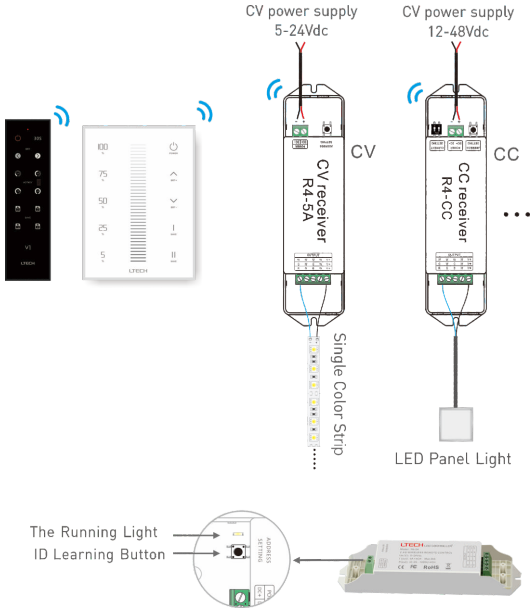

Match / Clear Code between UX1 (V1) & Receivers

Match Code:

Short press "ID learning button" on receiver (R4-3A/5A, R4-CC), then press any key on UX1 or V1. If the lamps flicker once, match successfully.

Clear Code:

Long press "ID learning button" on receiver (R4-3A/5A, R4-CC) for 5 seconds, If the lamps flicker twice, deactivate the matching successfully.

DMX System Wiring

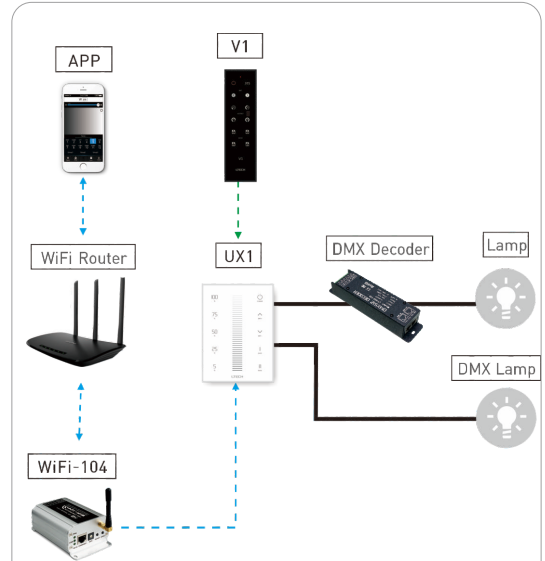

* PS: No WiFi router needed when WiFi-104 work with phones directly.

Match Code Sequence

1. Match WiFi-104 with UX1, which enables the smart phone to control DMX device via WiFi-104.
2. Match V1 with UX1, which enables V1 to control DMX device.

Wireless System Wiring

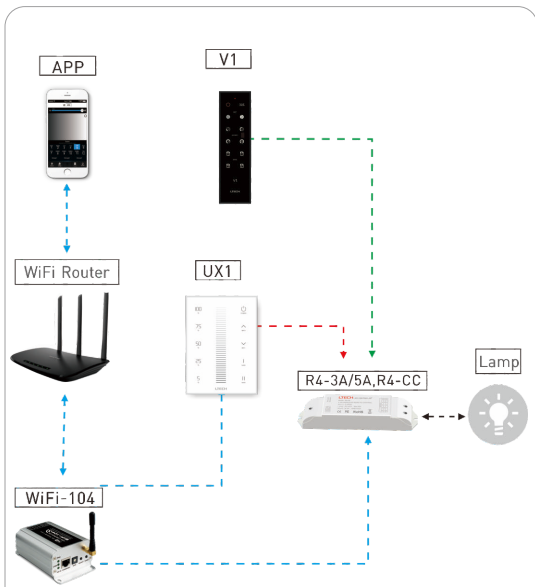

* PS: No WiFi router needed when WiFi-104 work with phones directly.

Match Code Sequence

1. WiFi-104 & UX1
2. UX1 & R4-5A/R4-CC
3. V1 & R4-5A/R4-CC

Match / Clear Code for UX1 & WiFi-104, V1, UX1

Match Code:

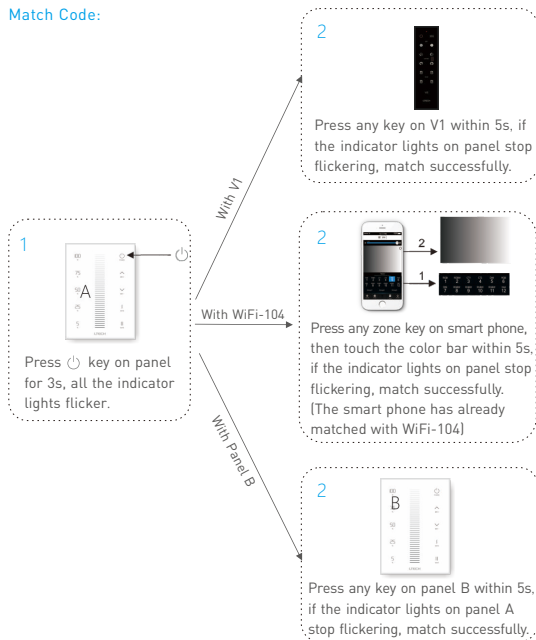

Clear Code:

